

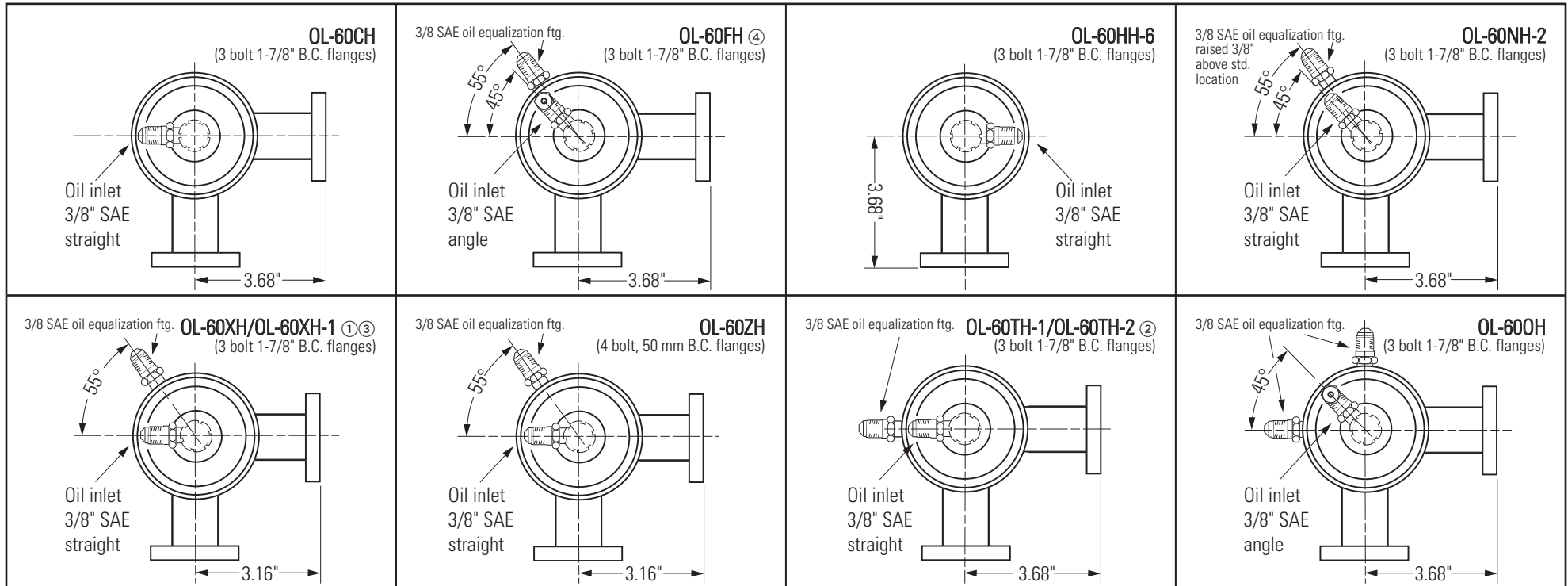

OIL LEVEL CONTROLS

January 2004 / Bulletin 310-10-1



- ① OL-60XH supplied **with** an oil equalization fitting. OL-60XH-1 supplied **less** an oil equalization fitting.
- ② OL-60TH-1 oil inlet and equalization fittings are at the 9 o'clock position. OL-60TH-2 oil inlet and equalization fittings are at the 12 o'clock position.
- ③ The OL-60XH/OL-60XH-1 and OL-60ZH controls have shorter arms than the other controls.
- ④ Replace the OL-2DH with the OL-60FH control. Cap off the oil equalization fitting.

All Sporlan oil level controls now incorporate the "60" port for product simplification. The "60" port is designed to handle a large operating range and replaces the "1" and "2" port oil level controls.

- OL-60CH replaces the OL-1CH and OL-2CH controls.**
- OL-60FH replaces the OL-1FH and OL-2FH controls.**
- OL-60HH-6 replaces the OL-1HH-6 and OL-2HH-6 controls.**
- OL-60NH-2 replaces the OL-1NH-2 and OL-2NH-2 controls.**

Internally all Sporlan OL-60 controls are identical. Different models exist because of installation requirements, space constraints (short arm versions), flange design or the desirability/location of the oil equalization fitting. The three bolt flange oil level controls are interchangeable provided it can be installed in the system. For oil level controls not shown above, contact Sporlan Valve Company.

COMPETITOR CROSS REFERENCE

AC & R MODEL NO.	FLANGE DESIGN	SPORLAN MODEL NO.
S-9010	3 bolt	OL-60FH or OL-60XH
S-9010A	4 bolt	OL-60ZH
S-9090	3 bolt	OL-60XH
S-9090A	4 bolt	OL-60ZH
S-9110	3 bolt	OL-60FH or OL-60XH
S-9120	3 bolt	OL-60FH or OL-60XH
S-9130	3 bolt	OL-60FH or OL-60XH
S-9190	3 bolt	OL-60FH or OL-60XH

Notes: Review the dimensional and oil inlet fitting configuration differences between the OL-60FH and OL-60XH controls. The OL-60XH has virtually the same dimensions as the AC&R controls. The oil inlet fitting on some of the AC&R controls point up whereas the oil inlet fitting on the OL-60XH points out. Often a slight change to the oil line will remedy this variance.

The oil inlet fitting points up on the OL-60FH. However, the arms of the control are 1/2 inch longer than the arms on the OL-60XH control. In applications where ample room exists, the OL-60FH is another option.

If the oil equalization fitting is not required on the Sporlan model, simply cap the fitting.

Sporlan oil level controls include a 100 mesh inlet screen whereas the AC&R controls do not.

OIL LEVEL CONTROL ADAPTOR KITS

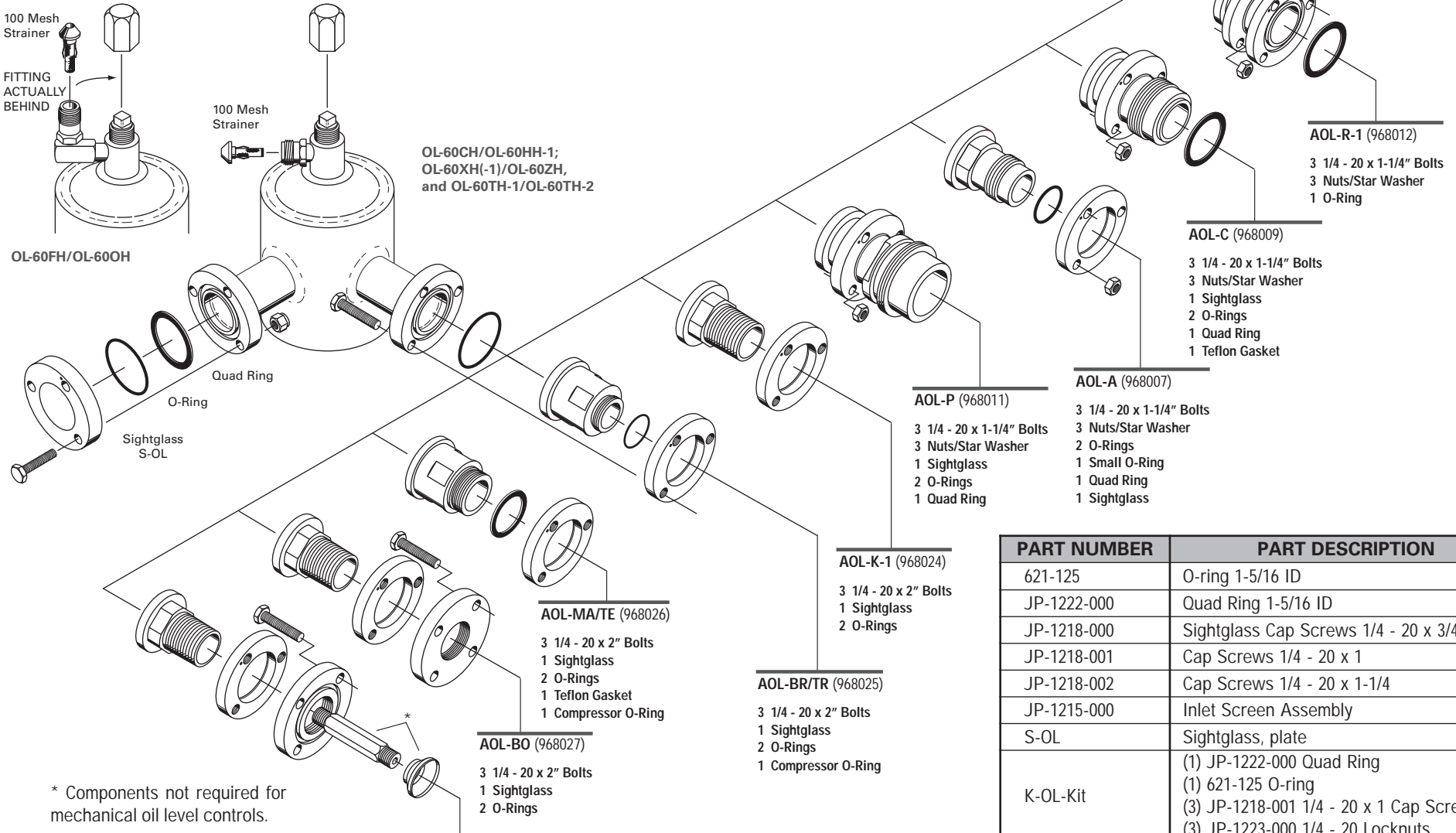

* Components not required for mechanical oil level controls.

Notes: Mechanical oil level control not recommended for scroll compressors.

The K-OL-Bitzer kit is required for O-ring replacement on the OL-60ZH control.

PART NUMBER	PART DESCRIPTION
621-125	O-ring 1-5/16 ID
JP-1222-000	Quad Ring 1-5/16 ID
JP-1218-000	Sightglass Cap Screws 1/4 - 20 x 3/4
JP-1218-001	Cap Screws 1/4 - 20 x 1
JP-1218-002	Cap Screws 1/4 - 20 x 1-1/4
JP-1215-000	Inlet Screen Assembly
S-OL	Sightglass, plate
K-OL-Kit	(1) JP-1222-000 Quad Ring (1) 621-125 O-ring (3) JP-1218-001 1/4 - 20 x 1 Cap Screws (3) JP-1223-000 1/4 - 20 Locknuts
K-OL-Bitzer Kit	(1) JP-1513-000 Quad Ring (1) 6498-000 O-ring (Bitzer sightglass) (3) JP-1218-001 1/4 - 20 x 1 Cap Screws (3) JP-1223-000 1/4 - 20 Locknuts

